

TOWNHOME

T8-20

BRANTWOOD

2,065_{SQFT}



3



3.5

FORECOURT

COLLECTION AT GREYSTONE



For How You

LIVE

Welcome to the epitome of refined living by eQ Homes.

Welcome to Forecourt Collection, an exclusive enclave of Townhomes and Semi-Townhomes in the heart of Greystone Village. Each residence utilizes a modern blend of materials to establish a distinctive architectural identity. Thoughtfully crafted, open-concept interiors, enhanced by upscale appointments, ensure families enjoy a fully optimized lifestyle that balances elegant form with intuitive function. This is Forecourt Collection. City living in a refined, riverside setting.

E. & O. E. All renderings are artist concept. The final park plan will be designed and constructed by the City of Ottawa Parks Department and will be done through a public process.



A village at

HEART

Greystone Village is an innovative community nestled in the heart of Old Ottawa East, envisioned by Ottawa's renowned teams: Regional Group, eQ Homes, and Hobin Architecture. Perfectly situated between Ottawa's scenic Rideau River and Rideau Canal. Embrace a lifestyle filled with walking trails, biking, and waterfront activities just steps from home. Discover a vibrant community offering arts, culture, shopping, dining, and entertainment – everything you desire, all in one place.

Complementing Greystone Village's vibrant location between two of Ottawa's most picturesque waterways is its Grande Allée, the historic treelined formal gateway and central boulevard that runs through the heart of the community. Here you'll find a bustling farmers' market, speciality stores, restaurants and cafés.

This home showcases warm caramel-toned hardwood flooring with rich texture, adding depth and inviting warmth throughout the living spaces. Coordinating caramel-hued bathroom cabinetry enhances continuity and brings a sense of natural elegance to private areas of the home. In the kitchen, crisp white cabinetry creates a bright, timeless foundation, elevated by black contrasting accents that add definition and a modern edge. Stone-look tiles in key areas introduce organic texture and visual interest, offering durability while complementing the warm wood tones and the high-contrast kitchen palette. Together, these finishes create a cohesive blend of warmth, sophistication, and modern design.

eQ Design Team



BRANTWOOD

FORECOURT
COLLECTION AT GREYSTONE

KITCHEN



Kitchen Sink
Stainless Double Bowl Undermount



Hood Fan
Cyclone Stainless Steel Insert



Door Pull
Brookridge Matte Black Pull



Kitchen Faucet
Align Matte Black



Cabinetry
Salem MDF White Cap



Countertop
Silestone Bronze Rivers Quartz



Backsplash
Centura 2.5x8 La Riviera Wheat - 1/3 Offset

FINISHES



Kitchen renderings are for illustrative purposes only. Final kitchen design, colours, finishes, and bulkheads may vary. Appliances not included. All renderings are artist concepts. E. & O. E.

INTERIOR DETAILS



Interior Doors
Madison 1 Panel



Interior Door Hardware
Halifax Matte Black

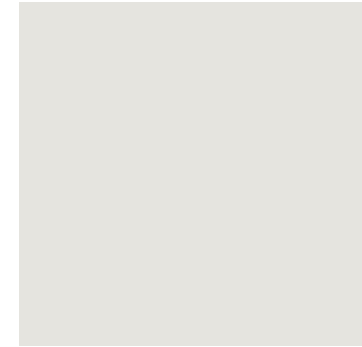

Interior Paint
Benjamin Moore OC-22 Calm



Main Entry Tile
12x24 Ceratec Paros White 1/3 Offset



Hardwood Flooring
Lauzon 4" Red Oak Carmelo



Trim Package
Trim Package #5

ENSUITE

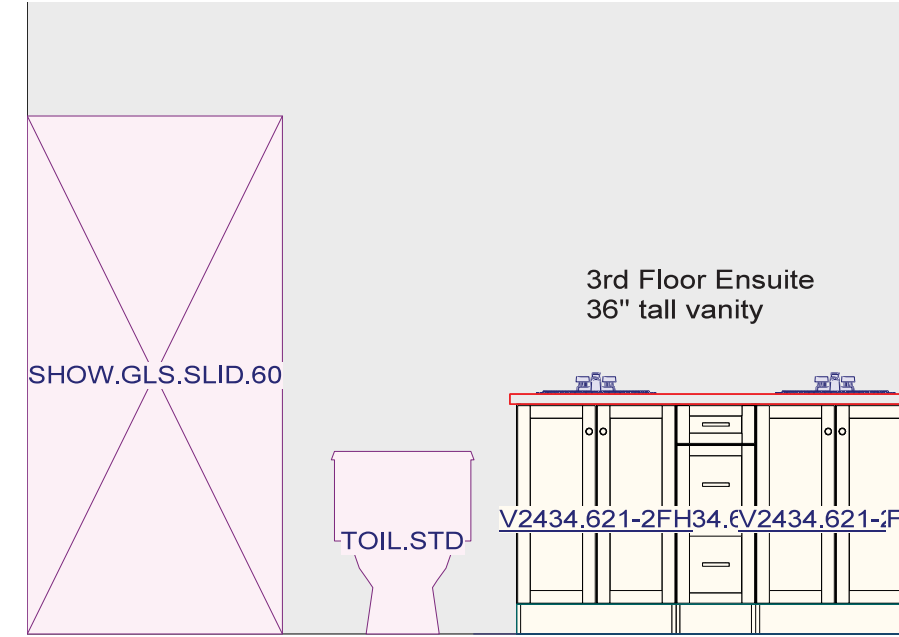

Cabinetry
Salem Maple Tuscan



Flooring
12x24 Centura Glocal Sugar - 1/3 Offset



Shower Wall Tile
12x24 Centura Glocal Sugar - 1/3 Offset



Countertop
Hanstone Markina Leathered



Toilet
Proflo Jerrit Toilet



Vanity Sink
Proflo Rectangular Undermount



Door Pull
Folklore Matte Black Handles & Knobs



Vanity Faucet
Align Matte Black



Shower Fixture
Align Matte Black

MAIN BATH

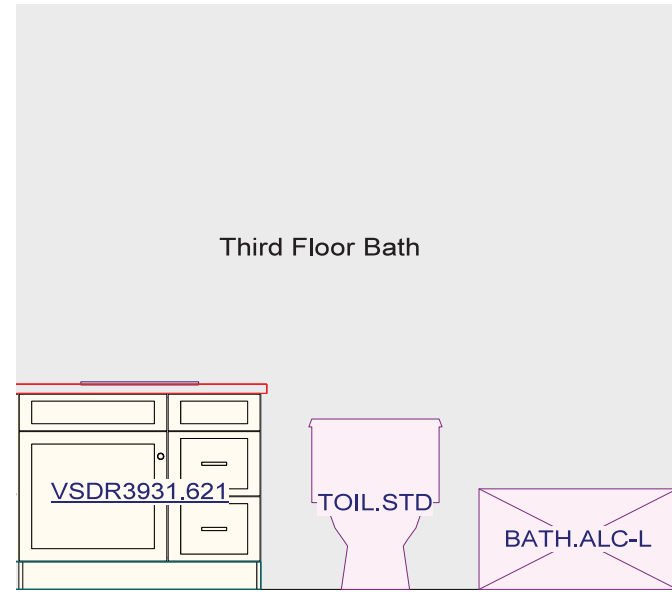

Toilet
Proflo Jerrit Toilet



Vanity Sink
Proflo Rectangular Undermount



Vanity Faucet
Align Matte Black



Door Pull
Folklore Matte Black Handles & Knobs



Tub/Shower Fixture
Align Matte Black



Cabinetry
Salem Maple Tuscan



Flooring
12x24 Ceratec Paros White 1/3 Offset

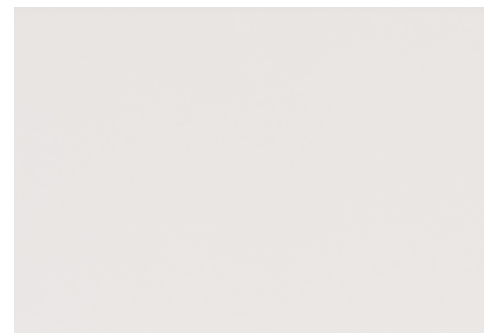

Shower/Tub Wall Tile
Euro 4x16 Pasha Soho Canvas White Matte - Horizontally Stacked



Countertop
Hanstone Antello Quartz

GROUND FLOOR BATH

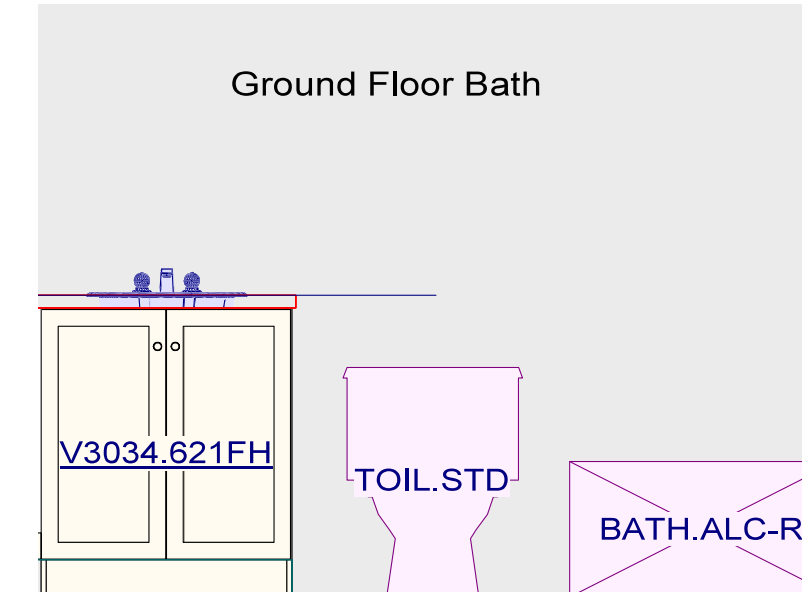

Toilet
Proflo Jerrit Toilet



Vanity Sink
Proflo Rectangular Undermount



Vanity Faucet
Align Matte Black



Door Pull
Folklore Matte Black Knob



Tub/Shower Fixture
Align Matte Black



Cabinetry
Salem Maple Tuscan



Flooring
12x24 Ceratec Paros White 1/3 Offset

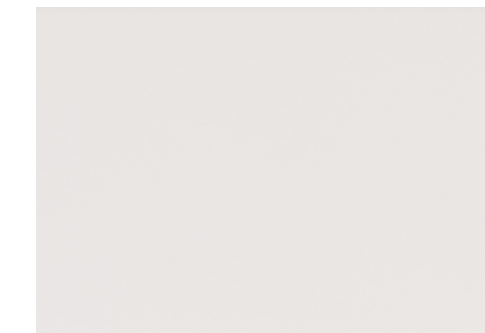

Shower/Tub Wall Tile
Euro 4x16 Pasha Soho Canvas White Matte - Horizontally Stacked



Countertop
Hanstone Antello Quartz

FIREPLACE AND RAILING DETAIL



Fireplace
Savannah BL 21 Linear



Railing
N/A

FOR THE
BEST
COMMUNITY
DESIGN

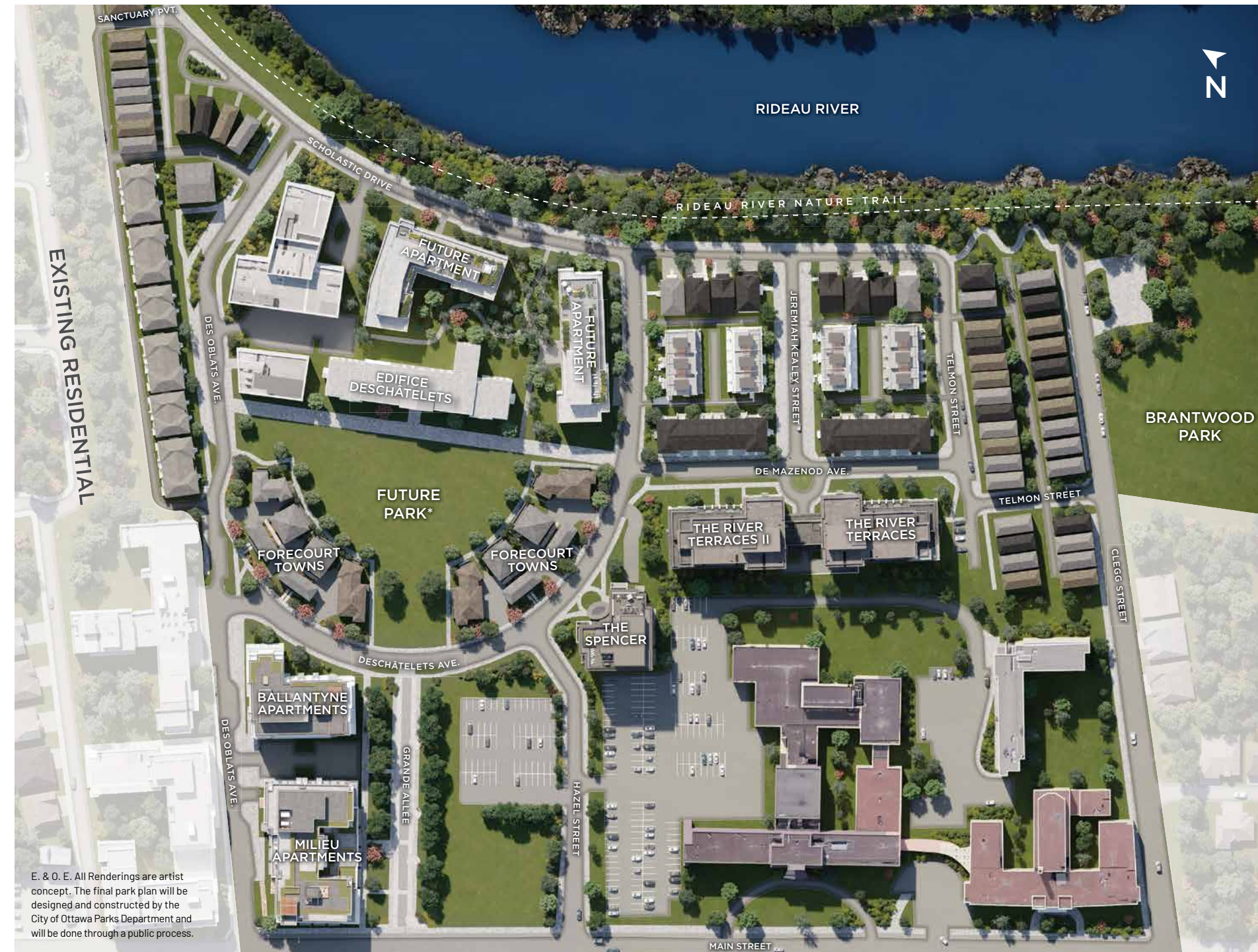

E. & O. E. All Renderings are artist concept. The final park plan will be designed and constructed by the City of Ottawa Parks Department and will be done through a public process.



E. & O. E. All renderings are artist concept.

Lindsay Callihoo

Sales and Leasing Consultant

EMAIL lcallihoo@eqhomes.ca

TEL 613.569.3043

ADDRESS 360 Deschâtelets Ave
Ottawa, ON K1S 5Y1

For more information, please call 613.569.3043
or contact the Leasing/Sales Office
using the 1Valet entry system.





Greystonevillage.ca/forecourt

DESIGNED BY RYAN DESIGN INTERNATIONAL