

THE RIVER

TERRACES

AT GREYSTONE

NOW UNDER CONSTRUCTION!

FLOOR 9/PENTHOUSE

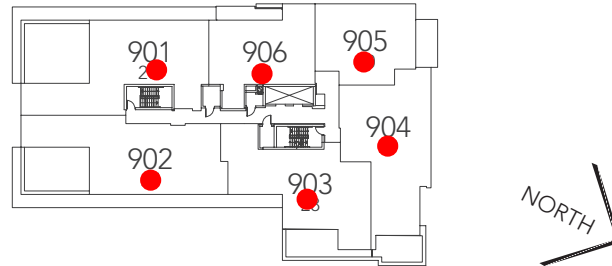

FLOOR 7

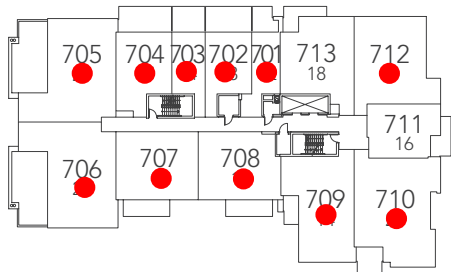

FLOOR 8

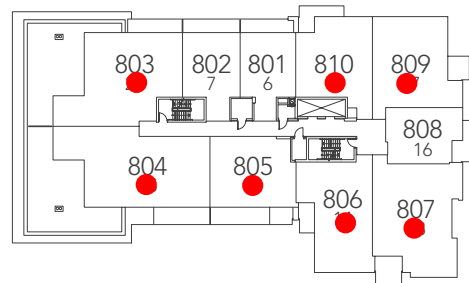

FLOOR 5

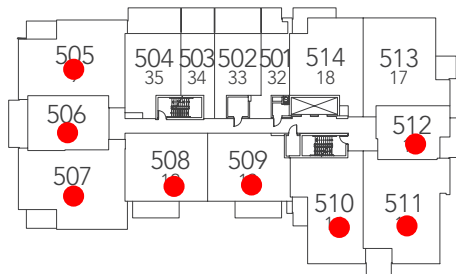

FLOOR 6

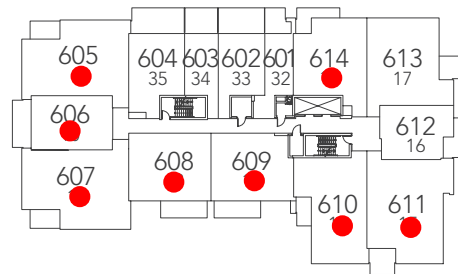

FLOOR 3

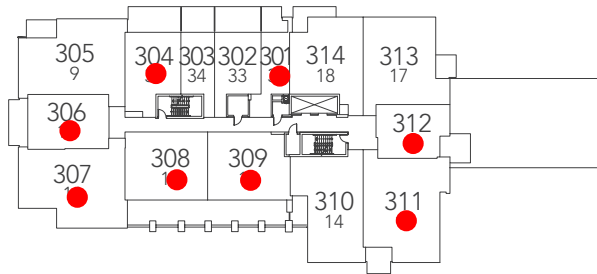

FLOOR 4

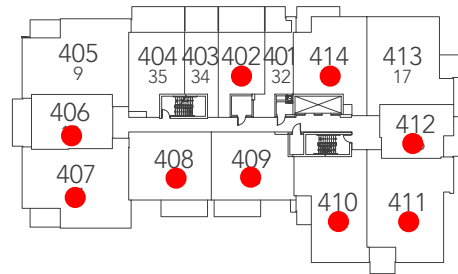

FLOOR 1

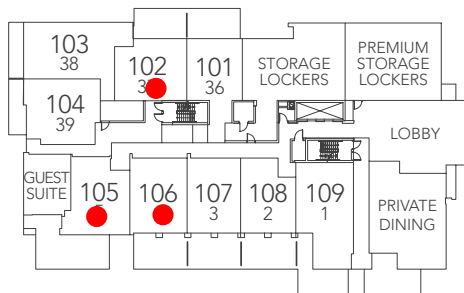

FLOOR 2

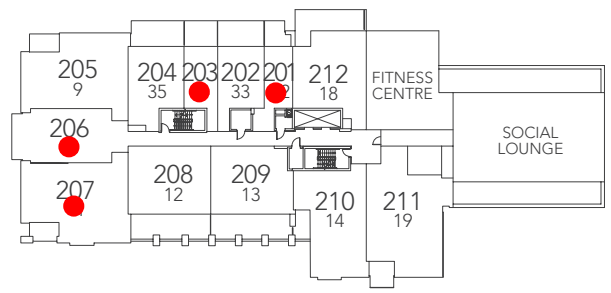

GREYSTONE VILLAGE

A VISIONARY RIVERFRONT COMMUNITY

MODEL	INDOOR SQ. FT.	OUTDOOR SQ. FT. **	FLOORS	PRICED FROM***
-------	----------------	--------------------	--------	----------------

SMART BACHELOR

32*	377	80	4,5,6	\$219,900
33*	514	147	2,4,5,6	\$274,900
34*	406	124	3-6	\$234,900

ONE BEDROOM

2	631	288	1	\$364,900
6	626	105	8	\$369,900
7	652	113	8	\$364,900
16*	593	100	6,8	\$331,900
35	669	186	2,4,5,6,7	\$354,900
36	710	101	1	\$364,900

ONE BEDROOM +

1	902	322	1	\$464,900
3	675	288	1	\$390,900
39	756	145	1	\$404,900

TWO BEDROOM

12	897	126-328	2	\$474,900
17	1096	76	3-6	\$543,900
18	954	109	2,3,5	\$471,900
38	942	131	1	\$484,900

TWO BEDROOM +

9	1217-1224	86-92	2-4	\$621,900
14	1097-1119	69-77	2-3	\$547,900
19	1379	104	2	\$692,900



CONDO FEES:

\$0.44 PER SQ. FT.

Includes: Building insurance. Reserve fund contribution. Upkeep of common areas. Water, Heating / Air Conditioning of common areas. Snow removal and landscaping. Janitorial services. The fees do not include individual unit electricity, water and hydro consumption which will be sub-metered.

PARKING:

Parking is available for \$35,000/Spot

Motorcycle Parking is available for \$15,000/Spot

Please note that there is no parking available for Models 16, 32, 33 & 34.

STORAGE LOCKER:

One Storage locker is included in the purchase price.

PREMIUM STORAGE LOCKER:

Premium Storage lockers are available for \$10,000+/Locker

DEPOSIT STRUCTURE:

10% Total Deposit

1. \$5,000 - At time of signing
- 2: 1/3 - (less initial deposit) 30 days following initial deposit date
- 3: 1/3 - 90 days following date of execution
- 4: 1/3 -180 days following date of execution

All deposits to be made out "Nelligan O'Brien Payne LLP, in Trust"