



Designer Finished Homes

# THE EVERITT

2,203 SQ. FT. | T24-01

WALK-OUT LOT



Classic in stature and design, The Everitt is a spacious end-unit 2-storey townhome that spans 2,203 sq. ft. and features four bedrooms, large modern kitchen, and open concept Great Room that is ideal for entertaining. It also has an extra recreation room in the basement, and a walkout through patio doors to a lush backyard. With a fine balance of contemporary and traditional designer-selected finishes throughout, The Everitt is a warm and inviting place to call home.



ELEVATION A

Artist's concept. E.&O.E.

# DESIGNER FINISHED HOME

A Designer Finished Home means it's a quick move-in that includes show-stopping features and finishes expertly selected for their timeless beauty. Our award-winning design team hand selected all of the features and finishes boasting a harmonious blend of the finest interior appointments.

## MEET THE DESIGNER

### BEHIND THE HOME



**SHANNON GRANGER**  
eQ Design Studio  
Manager

“A calm colour palette and warm ambiance is achieved here with light greys, white and black for a touch of modern contrast. Leaning into contemporary with traditional accents, you will adore the shaker-style cabinetry and Callacatta marble-like flooring, making you feel right at home.”







# OUR COMMUNITY



THE COMMUNITY  
SITE PLAN

THE MASTERPLAN



- \* Brick/stone skirt at side elevation
- ◆ Look-out
- + Walk-out

Artist's concept. Map is not drawn to scale. E.&O.E.

MAKE A GRAND ENTRANCE WITH AN  
EXQUISITE DOOR HARDWARE,  
FLOOR & TRIM PACKAGE

INTERIOR DETAILS



1



2



3

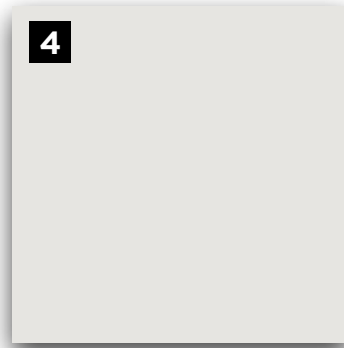

4



5

6



7

E.&O.E.

**1**  
**MAIN ENTRY  
TITLE**  
12x24 Euro  
Iroc - White

**2**  
**THROUGHOUT HOME /  
HARDWOOD FLOORING**  
Upg. Lauzon Essential  
Expert Collection Red  
Oak 3-1/8" x 3/4"- Caliza

**3**  
**CARPET**  
STD Beaulieu  
Coronet A4525  
Minotaur Carpet  
- Overcast

**4**  
**INTERIOR  
PAINT**  
Benjamin  
Moore OC-  
22 - Calm

**5**  
**INTERIOR DOOR  
HARDWARE**  
Weiser Westley  
Satin Chrome Levers  
- Satin Chrome

**6**  
**TRIM PACKAGE**  
Package #5  
Baseboard 2828,  
Casing L3513, Shoe  
Mould 4075-9

**7**  
**INTERIOR  
DOORS**  
Cambridge  
2 Panel  
Smooth

YOUR GUESTS WILL FIND YOUR  
POWDER ROOM MOST WELCOMING

## POWDER ROOM

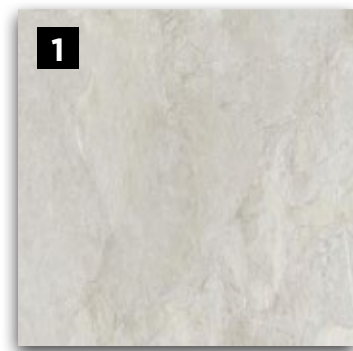

**1**  
**FLOORING**  
12x24 Euro  
Iroc - White

**2**  
**VANITY FAUCET**  
Genta 6702 Black  
1-Handle

**3**  
**VANITY SINK**  
Boulevard  
Pedestal Single  
Hole - White

**4**  
**TOILET**  
ProFlo- Jerrit  
2-Pc Single  
Flush - White



A GREAT RECIPE STARTS WITH A  
**GOURMET CHEF KITCHEN**

**KITCHEN**

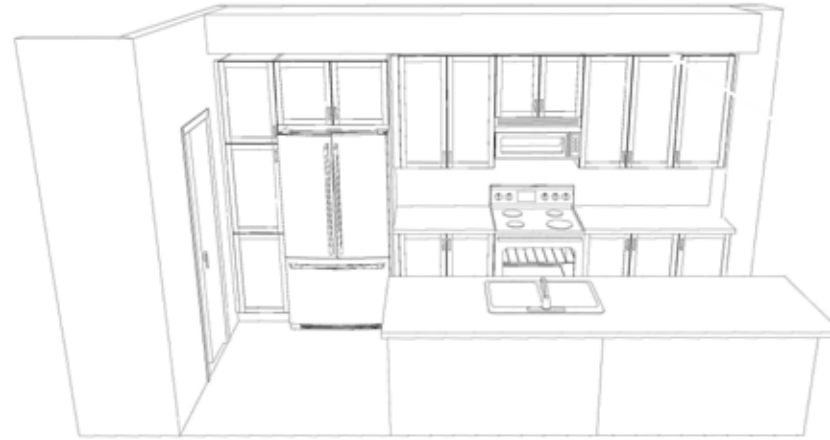

KITCHEN CABINET & ISLAND LAYOUT

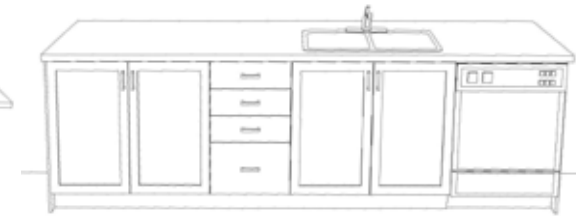

E.&O.E.

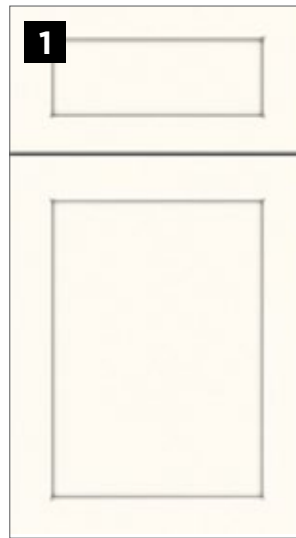

**1**



**2**



**3**



**4**



**5**



**6**

E.&O.E.

**1**  
**HOOD FAN**  
 GE  
 JVM2165SMSS  
 Microwave  
 Hoodfan

**2**  
**KITCHEN SINK**  
 Bristol B1807  
 Double Bowl  
 Undermount  
 Stainless Steel Sink

**3**  
**DOOR PULL**  
 Standard  
 Hardware  
 BP250128900  
 - Black Matte

**4**  
**COUNTERTOP**  
 Silestone  
 Group 1 - CTK-  
 SG1 - Blanco  
 Maple

**5**  
**BACKSPLASH**  
 2.5x8 Centura  
 Art Gloss -  
 Alabaster

**6**  
**CABINETRY**  
 Level 1 -  
 Thermofoil  
 Preston -  
 Texture White

**7**  
**KITCHEN FAUCET**  
 Sleek Spot Resist  
 Black Single  
 Hole 1-Handle

**A SUMPTUOUS PRIMARY ENSUITE  
YOUR COZY PRIVATE RETREAT**

**PRIMARY ENSUITE**



ENSUITE LAYOUT

E.&O.E.

**1**  
**CABINERY**  
Level 1 - Thermofoil  
Preston - Satin Cosmo

**2**  
**COUNTERTOP**  
Silestone Group 1 -  
CTK-SG1 - Miami Vena

**3**  
**FLOORING**  
13x13 Calacatta  
Matte

**4**  
**SHOWER/TUB WALL TILE**  
Ceratec 4x16 Essential Subway Tile  
- Horizontally Stacked - Bianco

**5**  
**DOOR PULL**  
Std Hardware 4114-  
1026-P Chrome

**6**  
**VANITY FAUCET**  
Genta 6702BL Black 1-Handle  
Bath Faucet - Black Matte

**7**  
**BATH ACCESSORIES**  
Genta Towel & Paper  
Holder - Black Matte

**8**  
**TUB FAUCET**  
Genta Tub Fixture  
- Black Matte

**9**  
**SHOWER FIXTURE**  
Genta Shower  
Fixture - Black Matte

**10**  
**VANITY SINK**  
ProFlo Undermount  
Sink

**11**  
**TOILET**  
ProFlo - Jerritt  
2pc HE - White

**12**  
**SHOWER DOOR**  
Maax Halo Sliding  
Door - Chrome



**MAIN BATH LAYOUT**

E.&O.E.

**1**

**CABINETRY**  
Level 1 -  
Thermofoil  
Preston -  
Texture White

**2**

**COUNTERTOP**  
Granite - CTB-  
GSSTD - Silver  
Pearl

**3**

**FLOORING**  
13x13  
Jefferson -  
Light Grey

**4**

**SHOWER/TUB  
WALL TILE**  
Ceratec 4x16  
Essential Subway  
Tile - Horizontally  
Stacked - Bianco

**5**

**DOOR PULL**  
Std Hardware  
4114-1026-P  
Chrome

**6**

**VANITY FAUCET**  
Genta 6702  
Chrome  
1-Handle Bath  
Faucet - Chrome

**7**

**SHOWER  
FIXTURE**  
Genta Shower  
Fixture -  
Chrome

**8**

**VANITY  
SINK**  
ProFlo  
Undermount  
Sink

**9**

**TOILET**  
ProFlo -  
Jerritt 2-pc.  
HE - White

ENJOY THE EASE AND LUXURY OF LIFE  
WITH THE HELP OF **MODERN APPLIANCES**

## APPLIANCES



**1**

**WASHER**

Whirlpool -  
5.4 cu. ft. Top  
Load Washer

**2**

**DRYER**

Whirlpool - 7.4  
cu. ft. Top Load  
Electric Dryer

**3**

**HOODFAN**

Base Package GE  
Over-the-Range  
Microwave

**4**

**RANGE**

LG - 30"  
Electric Smooth  
Top Range

**5**

**DISHWASHER**

LG - 24"  
Built-In Front  
Control

**6**

**FRIDGE**

LG - 36" Counter  
Depth French  
Door Fridge



### Congratulations On Selecting Your New eQ Home!



**Melissa Gauthier,**  
Director, Sales & Design

**1**

Sign Agreement of Purchase & Sale with your eQ Sales Representative.

Provide deposit cheques or complete EFT form *(if applicable)*

**2**

10-day rescission period starts. Review Agreement of Purchase & Sale with your Solicitor.

**3**

Provide Mortgage Pre-Approval from your lender.

**4**

Congratulations! Your new home purchase is now official and 10-day rescission period ends.

**5**

Receive access to your homeowner portal.

### Your New Home Construction Starts



**Peter Jury,**  
VP of Construction

**1**

Lot Walk. Meet the builder.\*\*

**2**

Receive a progress photo from Customer Care.

**3**

Roof is on and shingled. Customer Care to send progress photo.

**4**

Frame Walk with Customer Care and Construction Representative.\*\*

**5**

Walk-through for blinds and window coverings measurements.\*\*

**6**

Homeowner Orientation (PDI).\*\* Customer Care will walk you through your new home.

**7**

Register online for MyHome at Tarion.com.

**8**

Submit AVID Construction Survey.

### Welcome Home!



**Francesca Jacobs,**  
Customer Care Manager

**1**

Occupancy starts.

**2**

Submit 30-day Tarion Warranty if necessary.\*\*\*

**3**

Submit AVID Customer Satisfaction Survey (30 days after taking occupancy).

**4**

Closing day.

**5**

Election day turnover process begins.

**6**

Complete common elements performance audit survey.

**7**

Submit 1-year Tarion Warranty starts if necessary.\*\*\*

**8**

Submit 2-year Tarion Warranty starts if necessary.\*\*\*

**9**

3 to 7-year Tarion Warranty starts.\*\*\*

# Here's How We Bring You Home

\*\*This event may be in-person or virtual. If you have opted in to attend this appointment, an eQ Homes representative will contact you to confirm the details. \*\*\*See your Tarion Warranty for details.



**ALAIN LEGAULT**  
New Home Sales Consultant

235 L'etang Street,  
Clarence-Rockland, ON K4K 0K1  
TEL: 613-682-0167  
EMAIL: [alegault@eqhomes.ca](mailto:alegault@eqhomes.ca)



All drawings are artist's concept and may vary slightly from the final product. Actual usable floorspace may vary from stated area, and square footage has been calculated based on usable living space according to the TARION rules and does not include garage or unfurnished basement areas. Drawings may show optional features which may not be included in the base price. Bulkheads & box outs may be required as chases for plumbing & mechanical. Garage main door location, if applicable, may vary subject to grade. In an ongoing review of homeowner's needs, changes may have been incorporated into our "New Home Features" and construction techniques. Specifications subject to change without notice. Manufacturers' images are shown and may differ from the final product. E. & O.E. March 2023.